

## PR 30-HVS Quick Guide – Functions

### Basic Application

Press ON/OFF  
Wait for Laser

Slow beeping      Solid beep      Fast beeping

### Shock-Mode

1. Press ON/OFF
2. Shock-Mode activates automatically after 1 minute
3. If rotator is bumped, laser stops rotating and all LEDs activate

### Deactivation:

3. Press Shock-Mode button to deactivate Shock-Mode
4. LED indicates Shock-Mode is deactivated

### PRA 30 Settings

Press Volume Key to change Volume (normal/loud/off/low)

Press Unit Key to change units (mm/cm)

### Pairing:

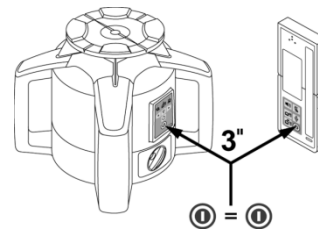

All tools sent out paired - Pairing only for new receiver!

1. Press and hold ON/OFF on both PR 30-HVS and PRA 30 for three seconds
2. LEDs blink, PRA beeps, Icon appears



# PR 30-HVS Quick Guide – Vertical Alignment

## Vertical Auto Alignment

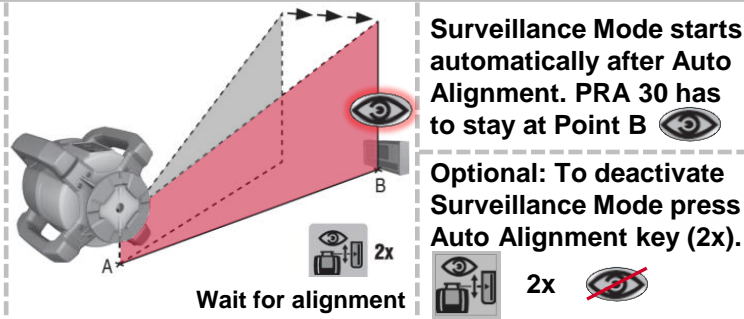
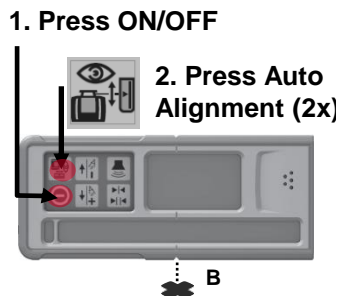
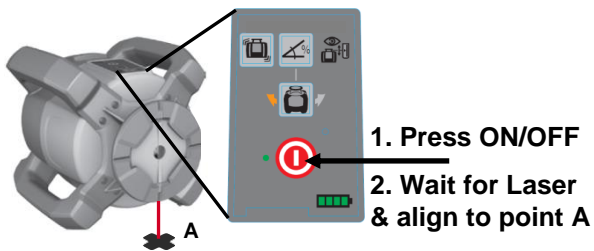

## Vertical Manual Alignment

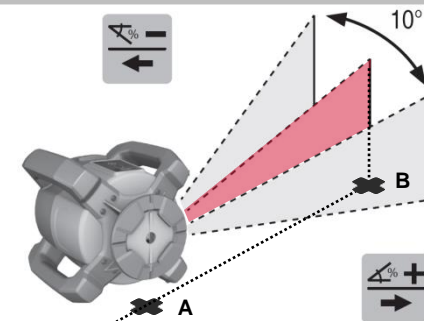
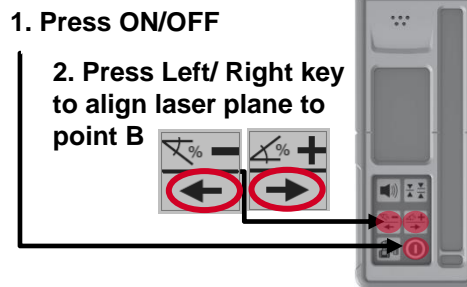
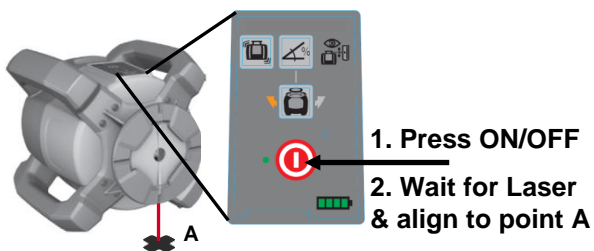

## PR 30-HVS Quick Guide – Slopes

### Setting Slopes

1. Use the target to aim & align tool to the desired slope
2. Press ON/OFF
3. Press Slope Mode key
4. Use + / - keys to set the desired inclination

Optional (for accurate direction):

### Slope e-Targeting

1. Set Slope as shown above
2. Press e-Targeting key
3. Position PRA 30

Turn tool according to LED arrow

When tool is aligned, press e-Targeting key to exit and start working with set slope.

### Determining Slopes

1. Use the target to aim & align tool to the slope
2. Press ON/OFF
3. Press Slope Mode key

Move PRA 30 on leveling staff to reference level next to rotator & fix it.  
Position the leveling staff to desired end point of slope and double click the auto-align key on PRA 30.

(2x)

\* Read the operating instructions before the tool is used for the first time

